

TOGGLE TERMINAL, HAND SWAGE

316 STAINLESS STEEL

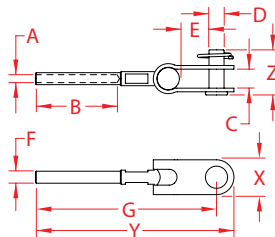

Import



Precision
Machined



Stamped

| ITEM | A (wire) | B | C | D | E | F | G | X (height) | Y (length) | Z (width) | WT (lb) | PACKAGING TYPE | EACH (qty) | INNER (qty) | CARTON (qty) | UPC |
|------------|-------------|-------|-------|-------|-------|-------|-------|---------------|---------------|--------------|------------|-------------------|---------------|----------------|-----------------|--------------|
| S0737-H003 | 1/8" | 1.51" | 0.38" | 0.24" | 0.45" | 0.21" | 3.13" | 0.59" | 3.40" | 0.82" | 0.07 | POLYBAG | 1 | 25 | 500 | 791506050100 |
| S0737-H005 | 3/16" | 2.01" | 0.38" | 0.24" | 0.45" | 0.30" | 3.80" | 0.59" | 3.96" | 0.82" | 0.10 | POLYBAG | 1 | 25 | 350 | 791506050117 |

NOTE:

DESIGNED FOR HAND SWAGE USE ONLY. MAKE INSTALLATION PAINLESS, USING SUNCOR'S HAND SWAGE LINE OF FITTINGS. THIS TOGGLE IS PERFECT FOR NUMEROUS MARINE, INDUSTRIAL AND ARCHITECTURAL APPLICATIONS. TOGGLE AND SWAGE FITTING ARE MADE FROM GRADE 316 STAINLESS STEEL. CRIMP THE HAND SWAGE STUDS ONTO THE WIRE ROPE USING THE HAND SWAGER (PART # E0113-H600). USE HAND SWAGER HOLE #1 ON 1/8" WIRE AND HOLE #2 ON 3/16" WIRE. ALL DIMENSIONS ARE NOMINAL (+/- 3%) AND ARE SUBJECT TO CHANGE WITHOUT NOTICE.